

# WOODSIDE CENTRAL

QUEENS, NY

RESIDENCE

## 1015 1115

STUDIO

1 BATHROOM

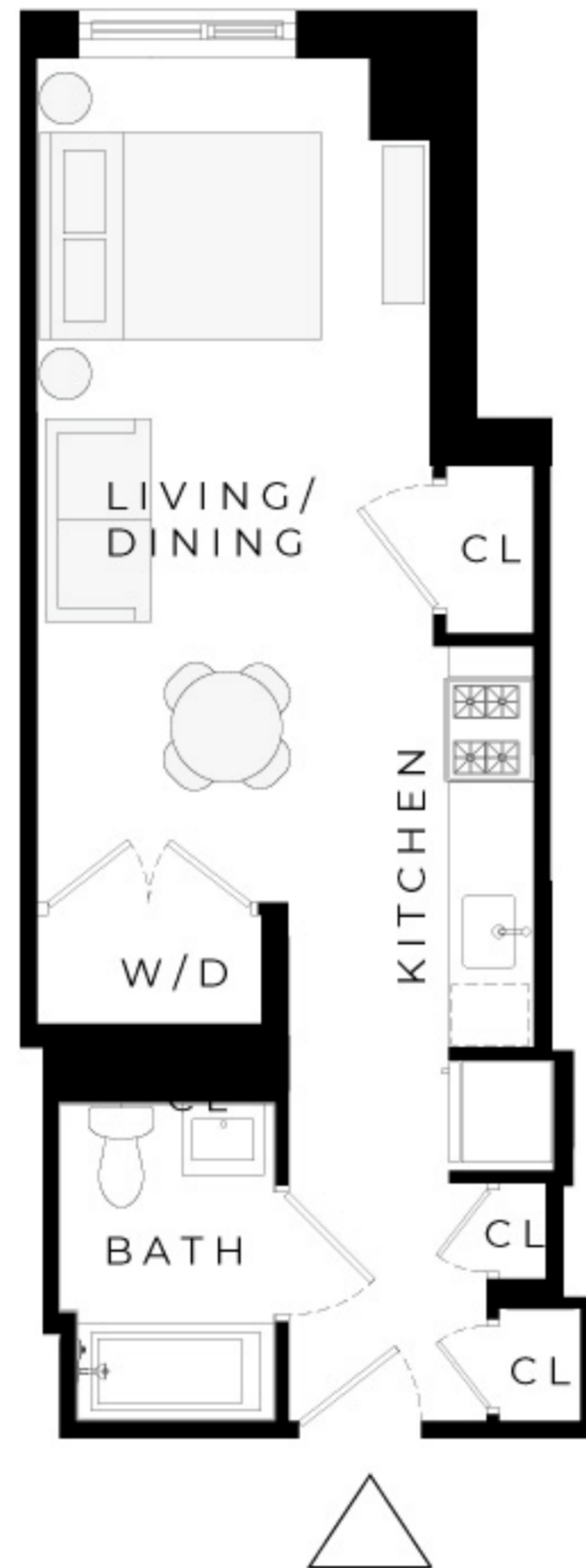

N



47TH AVENUE

70TH STREET

M.N.S  
REAL ESTATE  
NYC



ALL DIMENSIONS ARE APPROXIMATE AND SUBJECT TO NOMINAL CONSTRUCTION VARIANCE AND TOLERANCE. DIMENSIONS ARE MAXIMUM OVERALL, SUBTRACT CUTOUTS. LEASING AGENT IS PLEDGED TO THE LETTER AND SPIRIT OF U.S. POLICY FOR THE ACHIEVEMENT OF EQUAL HOUSING OPPORTUNITY THROUGHOUT THE U.S. AND IS COMMITTED TO AN AFFIRMATIVE ADVERTISING AND MARKETING PROGRAM IN WHICH THERE ARE NO BARRIERS TO OBTAINING HOUSING BECAUSE OF RACE, COLOR, CREED, RELIGION, SEX, SEXUAL ORIENTATION, MILITARY STATUS, AGE, DISABILITY, ANCESTRY, FAMILY STATUS, NATIONAL ORIGIN, OR ANY OTHER GROUNDS PROHIBITED BY CITY, STATE, OR FEDERAL LAW.